

SECONDARY PCB

PCB RASPBERRY PI MODEL B

SECONDARY PCB

106,3

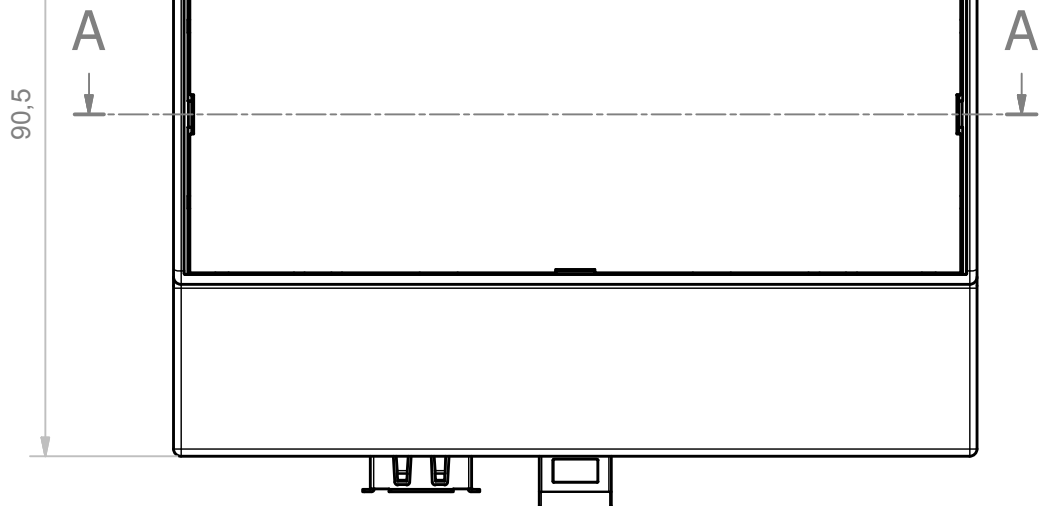
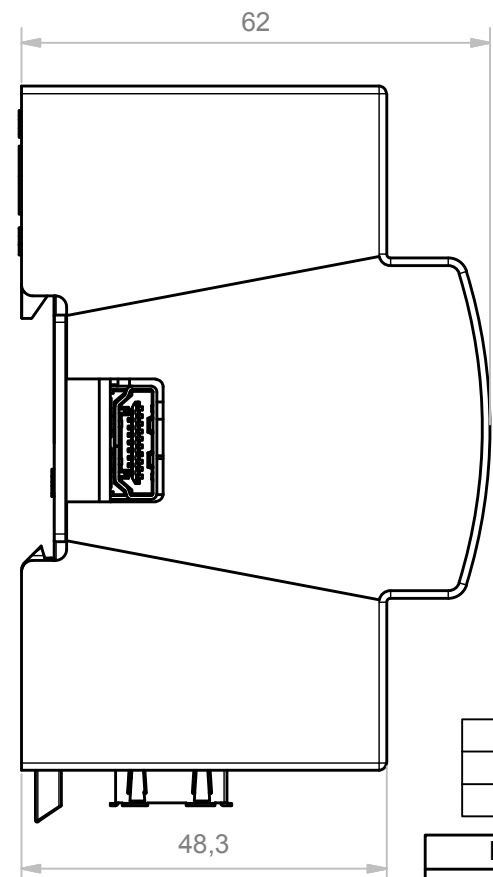
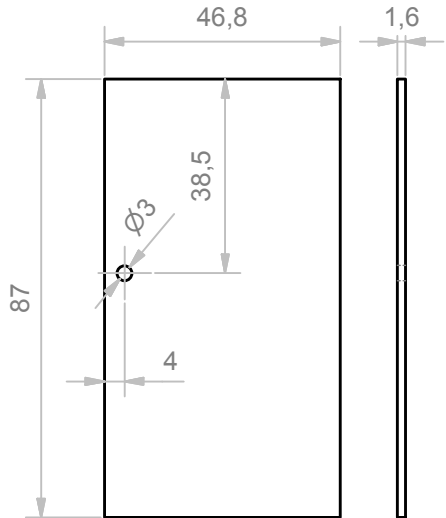

A-A (1:1)

| PCB TYPE | PCB DIMENS | TOLERANCE |
|----------|--------------|-----------|
| B | 102,5 x 86,4 | ±0,1 mm |
| C | 102,1 x 42,0 | ±0,1 mm |

| Da 0,5 a 3 | Oltre 3 fino a 6 | Oltre 6 fino a 30 | Oltre 30 fino a 120 | Oltre 120 |
|------------|------------------|-------------------|---------------------|-----------|
| ± 0,1 | ± 0,1 | ± 0,2 | ± 0,3 | ± 0,5 |

| | | | | | |
|--|-------------------------|--------------------|---|---|--|
| RESERVED PROPERTY The present drawing cannot be reproduced or communicated to 3d parties, even partially, without the authorization of ITALTRONIC Srl. Italtronic reserves to protect its own rights according to the law. | Dimension in mm | SHEET NR. 1 / 1 | DRAWING BY Manual modification are not allowed | GENERAL TOLERANCE UNI EN 22768/1 Media (m) | |
| | | Date: 06/10/2014 | Replace nr. | Revision description | |
| Drawed: Rigato N. | Checked: Dalla Montà D. | Scale: | | | |

Denomination: **Kit 6M XTS Raspberry Pi**

UN PARTNER PER IL FUTURO

ITALTRONIC S.R.L.
 VIA AUSTRIA 25/D 35127
 PADOVA - ITALY
 www.italtronic.com

Drawing nr. **M-05642-00**

| | | | | |
|---|---|---|---|---|
| 5 | 4 | 3 | 2 | 1 |
|---|---|---|---|---|