

All proprietary rights reserved by MTA S.p.A. - This drawing shall not be reproduced, or in any way utilized, for the manufacture of the component or unit herein illustrated and must not be released to other parties, without written consent. Any infringement will be legally pursued.

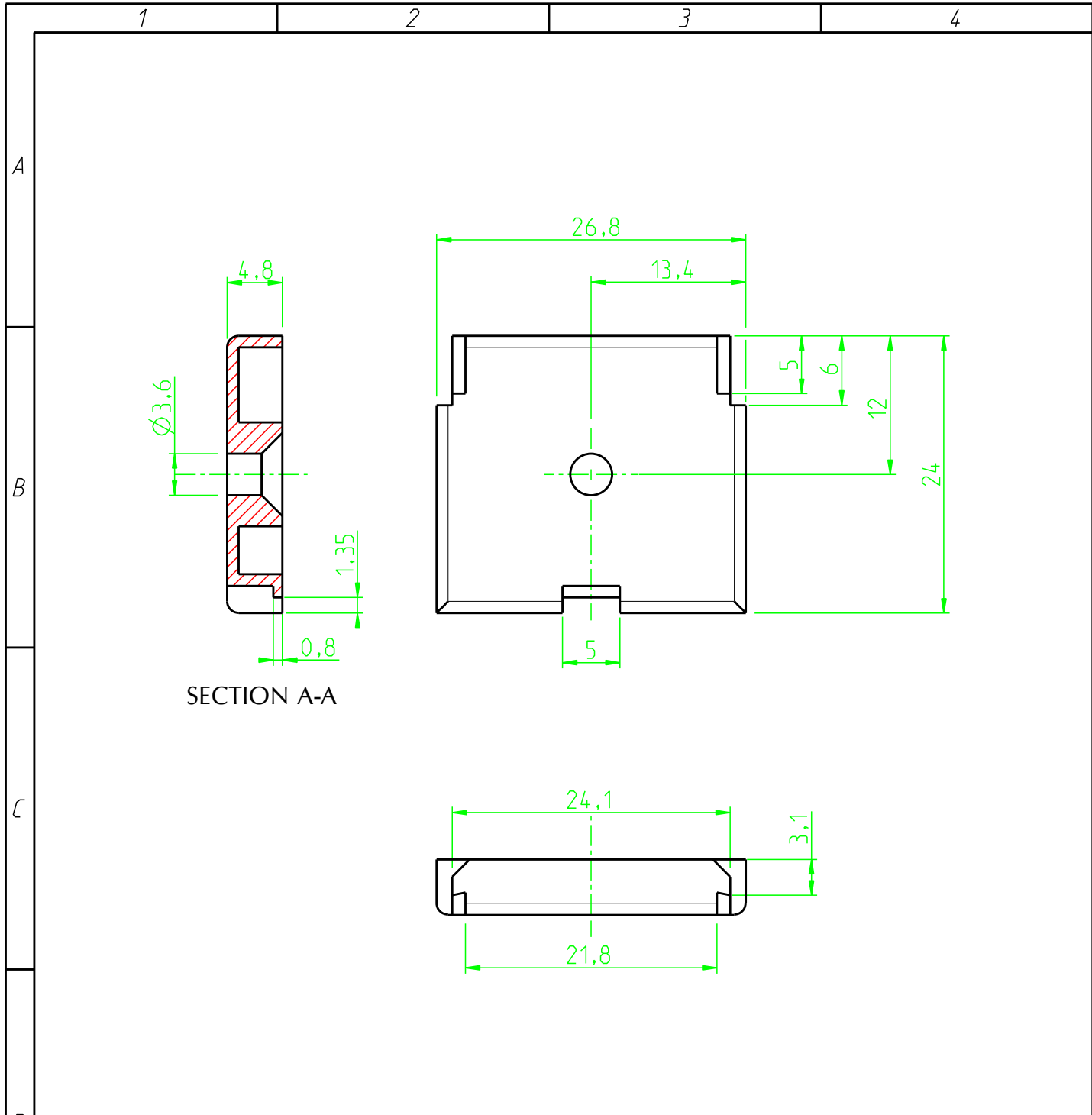

UNCONTROLLED COPY
 in case of drawing updating/revision
 NO AUTOMATIC
 resubmission will follow



| | | | | | | |
|---------------------|---------------|----------------------|-----------|----------------------|--------------------|--------------------------|
| MTA | | MTA P/N 0100352 | | Denom. FIXING PLATE | | |
| | | Draw No. BO-149.H01A | | Used for FUSE HOLDER | | |
| Rel. Level Approved | | Draw for CLIENT | | Relevant Standard - | | |
| Draft. | Date 09.03.92 | Name M.CORBANI | Scale 2:1 | Weight(g) 1.6 | Lin.Tol.± 0.5 | |
| Chk | Date 15.01.09 | Name M.CORBANI | A4 | | Ang.Tol.± - | |
| PQApp | Date 22.01.09 | Name R.GONZALEZ | | | Sheet 1/1 | Material PP GF30 |
| App. | Date 22.01.09 | Name M.CORBANI | | | Dimensions in (mm) | Coating - Color BLACK |

| | | | | | |
|-----|---------------------|------|----------|------|---------|
| 2 | LABEL MARK UPDATED | | | | |
| No. | Reason for Revision | Date | 15.01.09 | Name | R.DALMA |
| | | | | 3.0 | |