

WIFI-ANT405

WI-FI Internal Antenna

SRPASSIVES

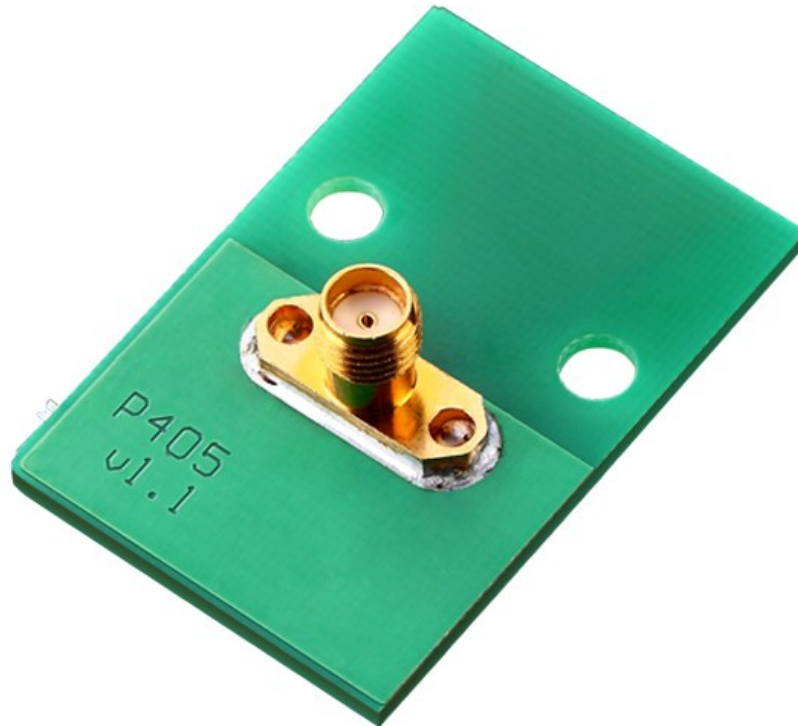
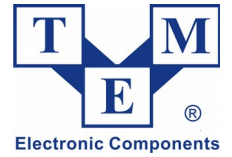

DIMENSIONS

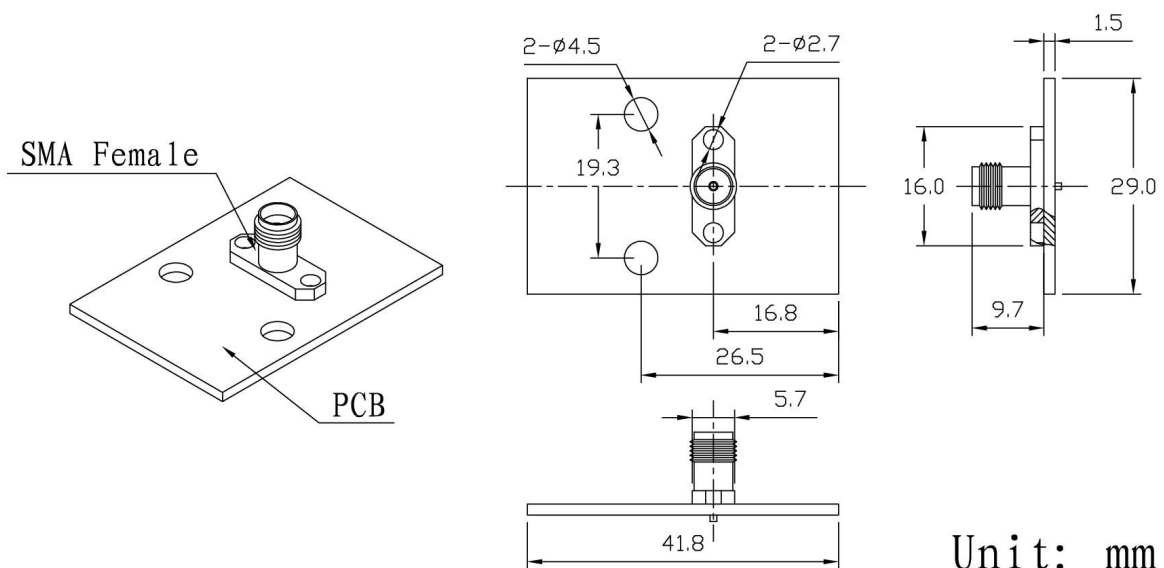

Unit: mm

SPECIFICATIONS

Item	Specifications	
Antenna	Frequency Range	2400~2483.5MHz
	Band Width	83.5MHz
	Polarization	Linear
	Gain	2dBi
	V.S.W.R	<2.0
	Impedance	50Ω
	PCB Dimension	41.8*29*1.5mm
	Connector	SMA female
	Mounting Method	Screw
Environmental	Operating Temperature	-40°C~+85°C
	Vibration	10 to 55Hz with 1.5mm amplitude 2hours
	Environmentally Friendly	ROHS Compliant

Radiation Pattern

