

C900AC SFTY X1-400 Y2-250, Ceramic, 1000 pF, 10%, 400 VAC (X1), 250 VAC (Y2), Y5P, Lead Spacing = 10mm

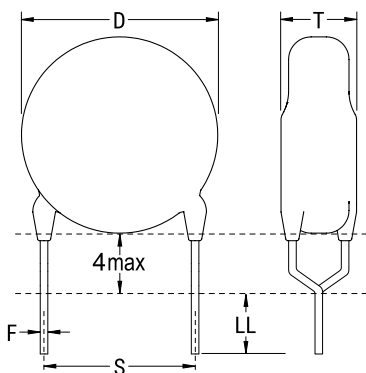

**Dimensions**

|           |                 |
|-----------|-----------------|
| <b>D</b>  | 9mm MAX         |
| <b>T</b>  | 5mm MAX         |
| <b>S</b>  | 10mm +/-1mm     |
| <b>LL</b> | 4mm +/-1mm      |
| <b>F</b>  | 0.55mm +/-0.1mm |

**Packaging Specifications**

|                            |           |
|----------------------------|-----------|
| <b>Packaging:</b>          | Bulk, Bag |
| <b>Packaging Quantity:</b> | 500       |

**General Information**

|                        |                           |
|------------------------|---------------------------|
| <b>Supplier:</b>       | KEMET                     |
| <b>Series:</b>         | C900AC SFTY X1-400 Y2-250 |
| <b>Style:</b>          | Radial Disc               |
| <b>RoHS:</b>           | Yes                       |
| <b>Termination:</b>    | Tin                       |
| <b>Failure Rate:</b>   | N/A                       |
| <b>Qualifications:</b> | UL, ENEC, VDE, CSA, CAN   |
| <b>Halogen Free:</b>   | Yes                       |

**Specifications**

|                                         |                            |
|-----------------------------------------|----------------------------|
| <b>Capacitance:</b>                     | 1000 pF                    |
| <b>Capacitance Tolerance:</b>           | 10%                        |
| <b>Voltage AC:</b>                      | 400 VAC (X1), 250 VAC (Y2) |
| <b>Dielectric Withstanding Voltage:</b> | 2600 VDC                   |
| <b>Temperature Range:</b>               | -40/+125C                  |
| <b>Temperature Coefficient:</b>         | Y5P                        |
| <b>Dissipation Factor:</b>              | 2.50%                      |
| <b>Insulation Resistance:</b>           | 10 GOhms                   |
| <b>Safety Class:</b>                    | X1/Y2                      |