

LED Power Supply Constant Voltage	
Model	LNB1212CV
Voltage	12V
Current	1A
Power	12W

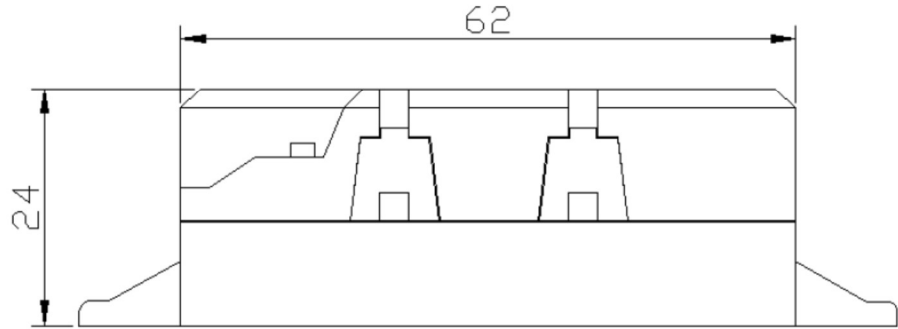

Input	Rated input voltage	230 VAC	
	Range of input voltage	220-240VAC	
	Frequency	50Hz	
	Power Factor	NC	
	Current	0.2 A MAX. @Full Load	
	Start-Up time	<0.5S for ERP @Full Load	
	Inrush Current	40A MAX. @Full Load. 240 VAC	
	Unload Power Consumption	≤0.5W	
Output	Unload voltage	12.6VDC MAX	
	Load Voltage rang	NA	
	Constant Voltage	12V	
	Voltage Accuracy	±5% @220-240VAC	
	Voltage Regulation	≤3%@Full Load	
	Hold-up Time	NA	
	Efficiency in full load	≥80%@Full Load ,240VAC	
	Power Max	12W	
Dimming	Dimmable or not	NA	
	Dimming mode	NA	
	Dimming current range	NA	
Protection	Over load Protection	105-150% Protection type: Auto Restore	
	Over Voltage Protection	>16VDC Protection type: Auto Restore	
	Short circuit Protection	Protection type: Auto Restore	
	Over Temperature protection	Protection type: Auto Restore	
HI-pot	Input-Output(V.AC)	3000V/5mA/1min	
	Input-FG(V.AC)	NA	
	Output-FG(V.AC)	NA	
Isolation	Leakage Current	<0.5mA(240VAC)	
	Input-Output(V.AC)	≥10MΩ@500VDC	
	Input-FG(V.AC)	NA	
Output-FG(V.AC)	NA		
	Environment/Life	Operating Temperature	-10°C...+40°C
		tc	85°C
Storage Temperature		-20°C...+60°C	
Humidity		20%-90%RH	
Life time		> 30,000h @40°C	
HSF requirement		RoHS	
Feature	Dmension	82*36*24(LXWXH)mm	
	Approval	CE	
Safety @ EMC	Safety standards	EN 61347-1; EN61347-2-13 EN60598-1; EN60598-2-6	
	EMI	EN55015; EN61000-3-2 Class C EN61000-3-3	
	EMS	EN61547; EN 61000-4-2 - 8KV; 4KV	
		Performance Criteria B	
		EN 61000-4-5 — 1000V; Performance Criteria C	

LED Power Supply Constant Voltage	
Model	LNB1212CV
Voltage	12V
Current	1A
Power	12W

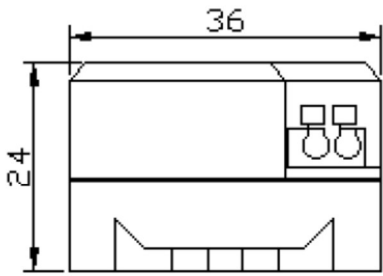
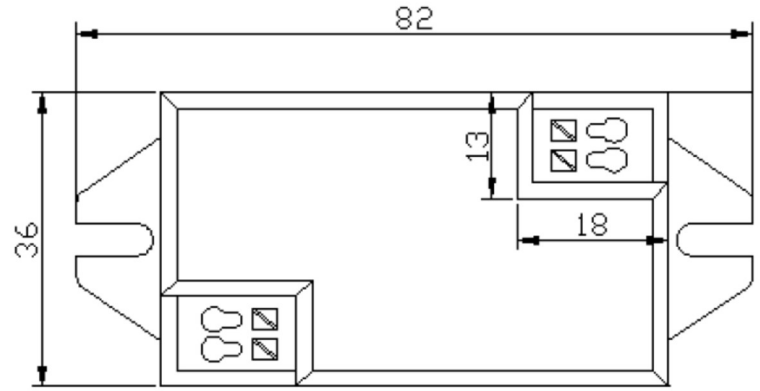

LABEL:

ESPE  **LED POWER SUPPLY**
LNB1212CV

INPUT.....230VAC
50Hz 0.2A

OUTPUT.....12V= 1A 12W

tc:85°C ta:40°C
Constant Voltage

L
PRI
230V~
N

M

M







F

110

tc

+
SEC
-

SELV

MADE IN CHINA