

Lade- und Batteriekontakt TK 54 B
Battery and Interface Probe

Hülse S 54 B
Receptacle

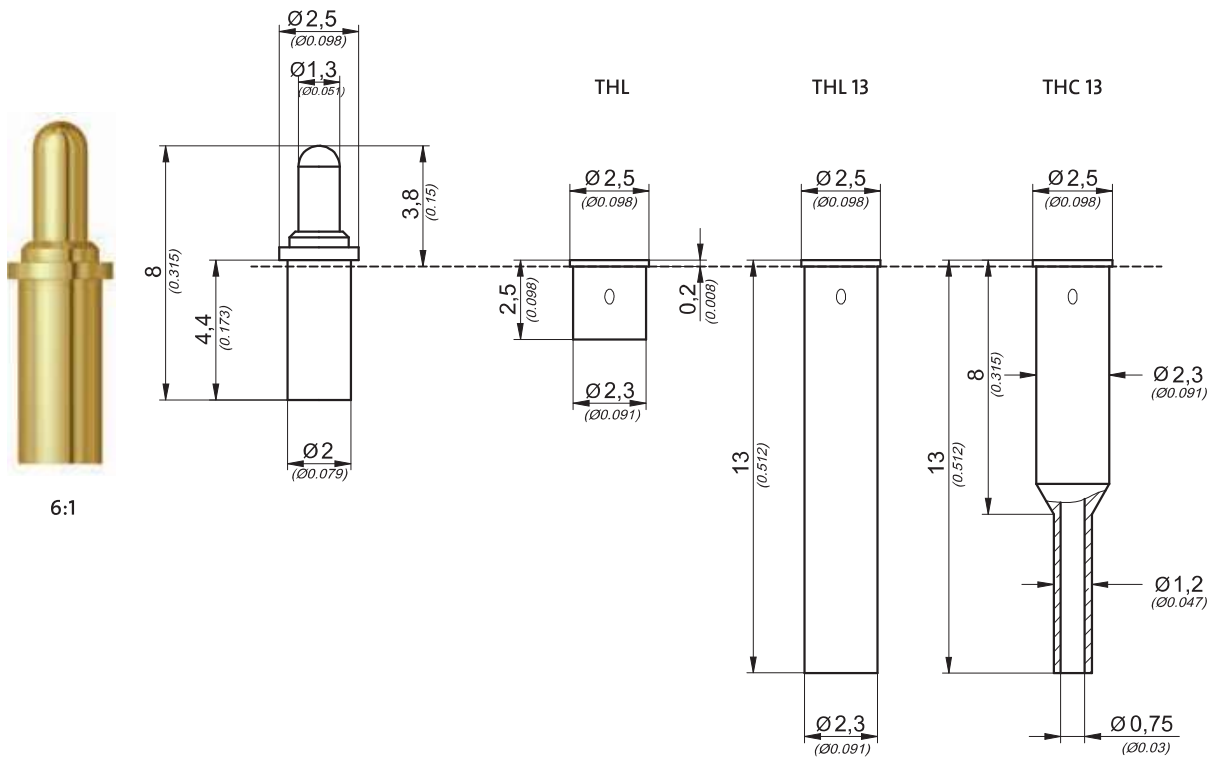

Serie Series TK 54 B

Kopfform Head Type	Nr. No.	Tastkopf Ø mm Probe Tip Ø inch	Werkstoff Material	Federkraft Spring Force in cN	Oberfläche Tastkopf Surface Probe Tip
	05	1,30 0.051	C	Standard 200 cN Standard 71 oz. Alternative 100 cN 50 cN Alternative 3.5 oz. 1.8 oz. +/- 20%	A

Technische Spezifikationen:
Technical Specifications:

Max. Federweg Max. Travel	2,2 mm 0.086 inch
Arbeitshub Working Stroke	1,5 mm 0.059 inch
Nennstrom Current Rating	1,5 A
Mittlerer Durchgangswiderstand Average Resistance	$R_m = 10 \text{ m}\Omega$
Standardabweichung Standard Deviation	$s = 1 \text{ m}\Omega$

Werkstoffe:
Materials:

Führungshülse Probe Barrel	Messing vergoldet Brass gold plated
Feder Spring	Stahl versilbert Steel silver plated
Kolben (Kopf) Plunger (Head)	CuBe (C) vergoldet (A) CuBe (C) gold plated (A)

Bestellbeispiel:
Ordering Example:

Federkontaktstift
Spring Contact Probe

TK54B.	05.	1,30.	C.	200.	A
Serie Series	Kopfform Headtype	Tastkopf Probe tip	Werkstoff Material	Federkraft Springforce	Oberfläche Surface

TK54B.05.1,30.C.200.A

Hülse
Receptacle

S54B.	THL
Serie Series	Hülseart Receptacle Type

S54B.THLL