

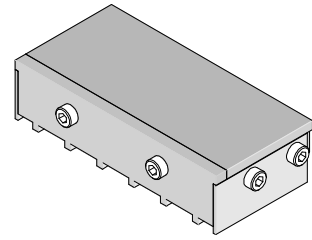

**1-by-6  
SFP+  
Insertion Tool**

**Application Tooling  
Specification Sheet**



**Order No. 62202-9830**

**FEATURES**

- Lightweight tool used in the insertion of a SFP connector in a PCB
- Inserts connector to a PCB without damage to the board
- Use tool 62202-9840 for removing connectors

**SCOPE**

Products: Small Form-factor Pluggable (SFP+) 1-by-6 Multi-Port Connector with Press-fit PC Tails

Connector Series No.	Connector Order No.			
74754	74754-0610	74754-0611	74754-0612	74754-0614
	74754-0620	74754-0621	74754-0624	
111111	111111-0610	111111-0620		
111112	111112-0610	111112-0620	111112-0650	111112-0660

**Notes:**

1. See the following pages for tooling operation instructions.
2. These tools require a "Keep Out Zone" around the connector free of components. ★ The rear of the connector should be .200" (5.08mm). The right and left sides should be .080" (2.00mm). See Figure 1.

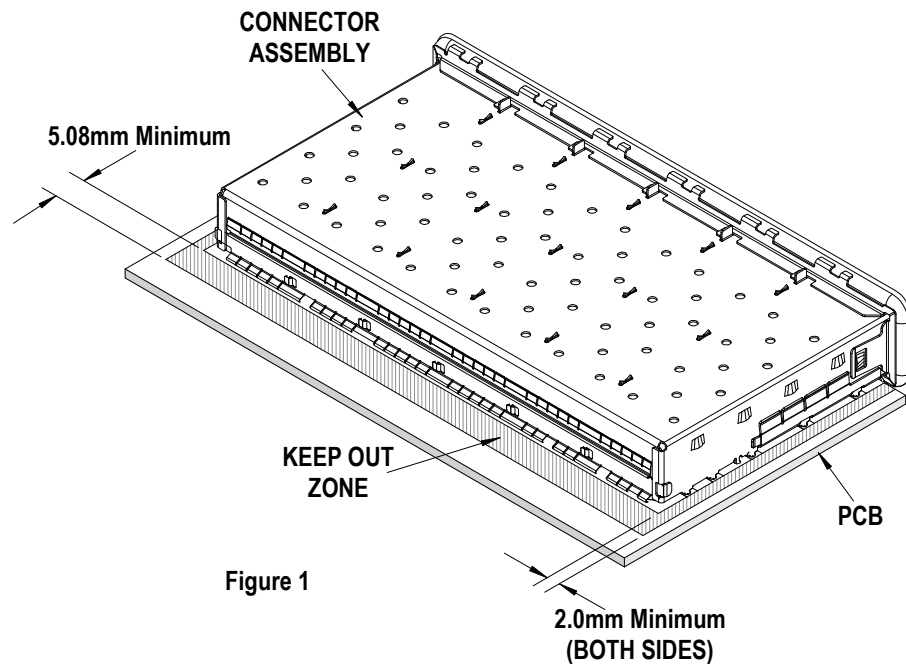

Figure 1

★ Note: The Keep-Out Zone applies to components other than the LEDs (used for the light pipe option).

## Description

The following Instructions are used for inserting connectors 1 by 6 into a PCB.

## Operation

1. Place a connector assembly on the PCB.
2. Place the tool on the connector assembly (closed end to the back end of the connector). See Figure 2.
3. Place tool, connector, and PCB, in a press of suitable size and force, and seat the connector assembly.

Note: The insertion tool does not contact the PCB when the connector is fully seated.

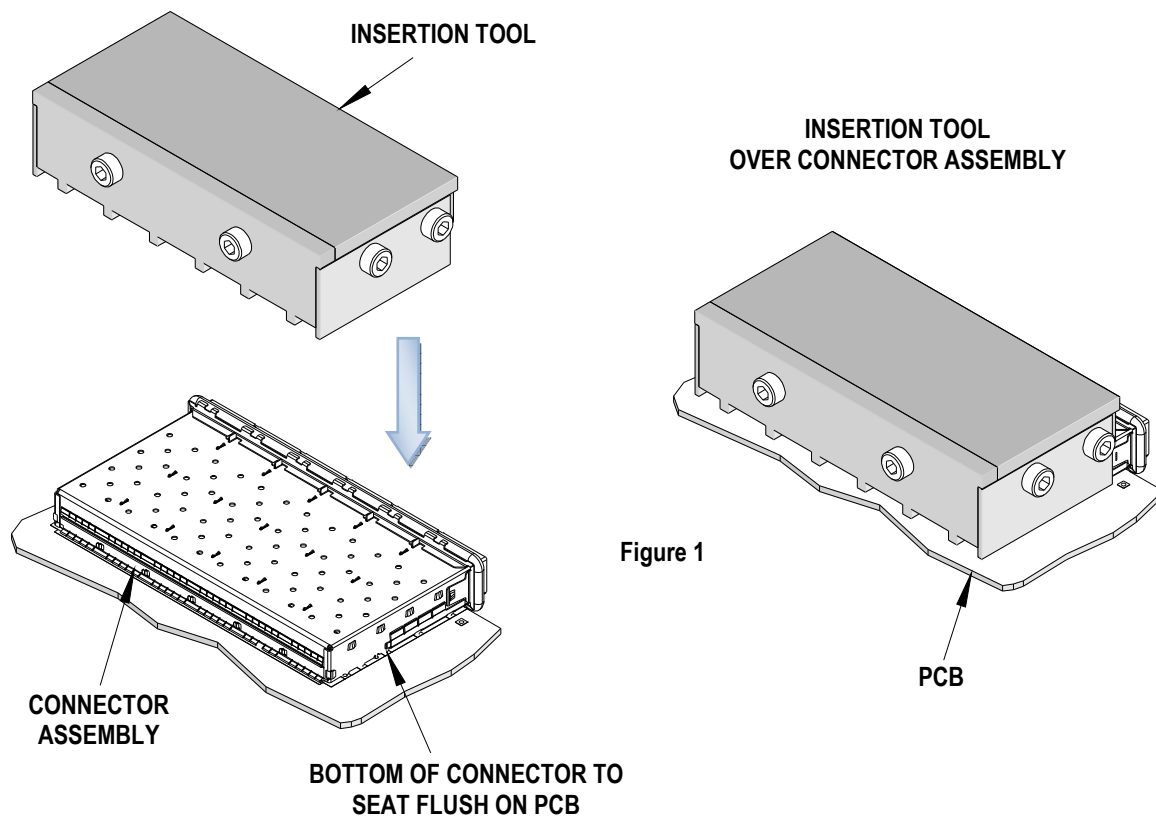

Visit our Web site at <http://www.molex.com>