

BN 388

Cross recessed flat countersunk
head screws
Phillips H

DIN 965 A
~ISO 7046
~UNI 7688

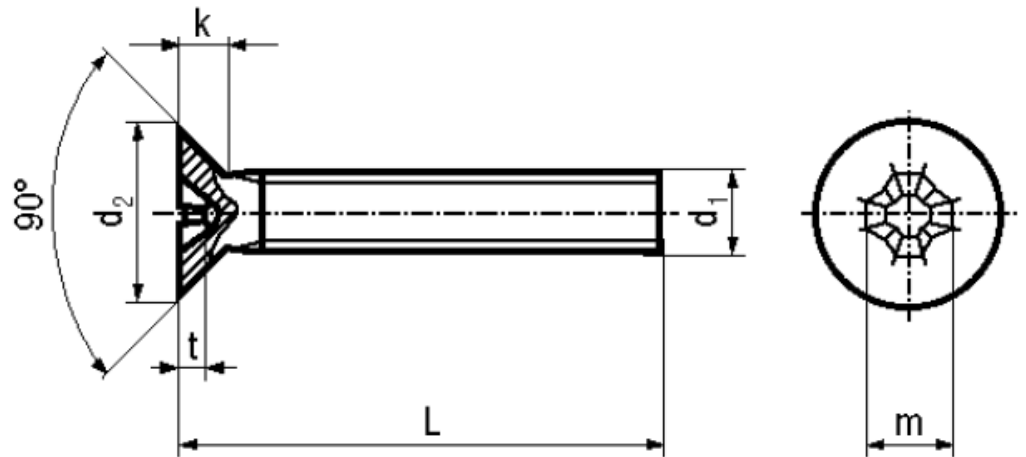

| | | | |
|----------|-------------------------|---------------------------|-----------------------------|
| Material | Steel | Tensile strength | 400 N/mm² |
| Surface | zinc plated blue | Elongation after fracture | min. 14% |
| Quality | 4.8 | | |

Article No. - 1156446

| | |
|---------------------|------|
| d ₁ | M3 |
| L | 5 |
| d ₂ max. | 5,6 |
| k max. | 1,65 |
| Phillips | 1 |
| m~ | 2,9 |
| t min. | 1,5 |
| t max. | 1,8 |

DIN 965 A: Standard withdrawn and replaced under European standardization by the corresponding ISO standard.
All lengths fully threaded.

DIN 965 A Prozidriv cross recess (Type Z) see BN 3333