

GN 425.1

Double-curved handles

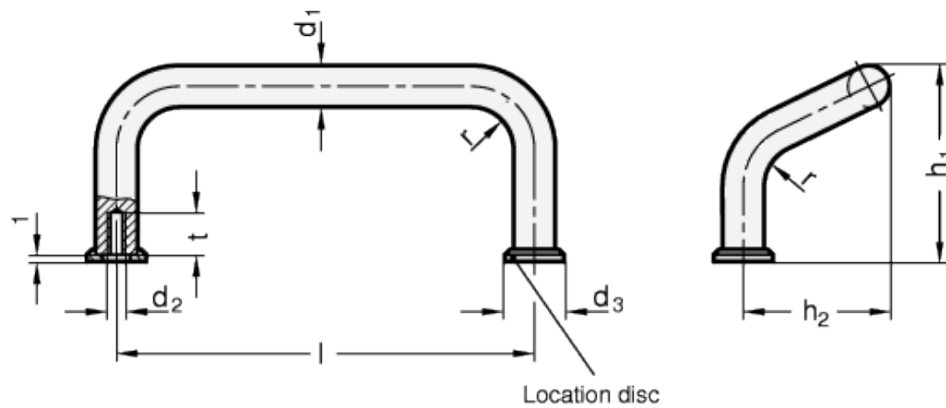

technical informations

Material

Chrome-plated steel. Round cross section bar.

Assembly

Tapped blind holes.

Washers

Zinc-plated steel, supplied not assembled.

Special executions on request (For sufficient quantities)

Different lengths.

Standard Elements

Main dimensions

Mounting holes

Weight

Description	d ₁	l _{±0.25}	d ₃	h ₁	h ₂	r	d ₂	t _{min.}	g
GN 425.1-10-88-CR	10	88	15	47	35	12	M5	12	113
GN 425.1-10-100-CR	10	100	15	47	35	12	M5	12	120
GN 425.1-10-120-CR	10	120	15	47	35	12	M5	12	132



ELESA and GANTER models all rights reserved in accordance with the law. Always mention the source when reproducing our drawings.

STANDARD MACHINE ELEMENTS WORLDWIDE