

Spherical bearing: KGLM

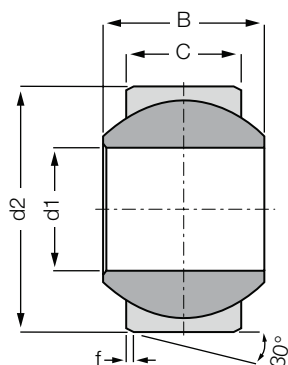

- Compensation of misalignment and edge loads
- Corrosion resistance
- High vibration-dampening
- Excellent vibration dampening
- Suitable for rotating, oscillating and axial movements

Order key

Type Size [mm]

K GL M -02

Dimensional series K
Pressfit spherical bearings
Metric
Inner Ø

i **Material:**
Housing: **igumid G** ▶ Page 1496
Spherical ball: **iglidur® W300** ▶ Page 153

inch **Imperial dimensions available**
▶ Page 1454

mouse **Lifetime calculation online**
▶ www.igus.eu/igubal-expert

Technical data and dimensions [mm]

Part No.	Max. static compressive strength		Max. tightening torque through ball [Nm]	d1 E10	d2	B	C	f	Max. pivot angle	Weight [g]
	radial [N]	axial ²⁹⁾ [N]								
KGLM-02	300	60	1	2	8	4	3.0	0.8	32°	0.1
KGLM-03	550	200	2	3	10	6	4.5	0.8	32°	0.5
KGLM-05	1,300	500	5	5	13	8	6.0	0.8	30°	1.0
KGLM-06	1,800	650	10	6	16	9	6.5	0.8	29°	1.6
KGLM-08	2,700	1,200	12	8	19	12	9.0	0.8	25°	2.9
KGLM-10	4,000	1,400	20	10	22	14	10.5	0.8	25°	4.4
KGLM-12	5,400	1,500	30	12	26	16	12.0	0.8	25°	7.0
KGLM-14	6,000	2,500	35	14	28	19	13.5	0.8	23°	9.1
KGLM-16	8,000	3,000	40	16	32	21	15.0	0.8	23°	12.8
KGLM-18	9,000	4,000	45	18	35	23	16.5	0.8	23°	16.6
KGLM-20	10,000	5,000	55	20	40	25	18.0	0.8	23°	24.4
KGLM-22	11,700	6,500	60	22	42	28	20.0	0.8	22°	28.5
KGLM-25	13,600	7,500	65	25	47	31	22.0	0.8	22°	39.3
KGLM-30	20,000	9,000	70	30	55	37	25.0	1.0	22°	62.6

²⁹⁾ The maximum static axial load is determined in a remote location hole