

Spherical bearing: EGLM

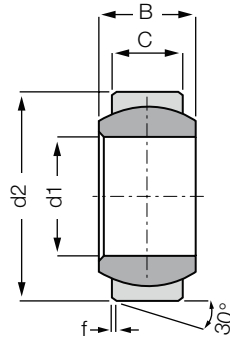

- Compensation of misalignment and edge loads
- Corrosion resistance
- High vibration-dampening
- Excellent vibration dampening
- Suitable for rotating, oscillating and linear movements



Order key

Type Size [mm]

E GL M -04

Dimensional series E	Pressfit spherical bearings	Metric	Inner Ø
----------------------	-----------------------------	--------	---------



Material:

Housing: **igumid G** ▶ Page 1496

Spherical ball:

Spherical balls with 04–30 mm diameters made from **iglidur® W300** ▶ Page 153

Spherical balls with 40 mm diameter made from **iglidur® J** ▶ Page 141



Lifetime calculation online

▶ www.igus.eu/igubal-expert

Technical data and dimensions [mm]

Part No.	Max. static compressive strength		Max. tightening torque through ball [Nm]	d1 E10	d2	B	C	f	Max. pivot angle	Weight [g]
	radial	axial ²⁹⁾								
	[N]	[N]								
EGLM-04	600	50	1	4	12	5	3.0	0.5	37°	0.4
EGLM-05	1,000	130	2	5	14	6	4.0	0.5	33°	0.8
EGLM-06	1,200	150	2.5	6	14	6	4.0	0.5	27°	0.9
EGLM-08	1,800	175	7	8	16	8	5.0	0.5	24°	1.2
EGLM-10	2,500	400	14	10	19	9	6.0	0.5	24°	1.9
EGLM-12	3,800	650	25	12	22	10	7.0	0.5	21°	2.8
EGLM-15	5,500	1,000	30	15	26	12	9.0	0.5	21°	6.9
EGLM-16	6,000	1,150	32	16	28	13	9.5	0.5	21°	9.0
EGLM-17	6,300	1,200	35	17	30	14	10.0	1.0	21°	10.6
EGLM-20	9,000	1,400	40	20	35	16	12.0	1.0	18°	16.3
EGLM-25	14,000	2,900	55	25	42	20	16.0	1.0	16°	29.0
EGLM-30	17,000	4,000	70	30	47	22	18.0	1.0	13°	37.4
EGLM-40	22,500	2,500	80	40	62	28	22.0	1.0	15°	57.0

²⁹⁾ The maximum static axial load is determined in a remote location hole