

ENCLOSURE FOR COMMAND DEVICES, 22MM, ROUND,  
ENCLOSURE MATERIAL METAL, ENCLOSURE TOP PART GRAY,  
6 COMMAND POINTS, UNEQUIPPED, RECESS FOR LABELS,  
BASE MOUNTING, TOP AND BOTTOM 1 X M25 EACH



Figure similar

product brand name	SIRIUS ACT
Product designation	Commanding and signaling devices
Design of the product	Surface-mounted housing

Enclosure:	
Design of the housing	with recess for label
Shape of the enclosure front	rectangular
Material of the enclosure	metal
Number of command points	6
Product component	
• protective collar	No
Color	
• of top part of the enclosure	grey
Mounting type of the enclosure	Vertical / horizontal

General technical data:	
Protection class IP	IP66, IP67, IP69(IP69K)
Degree of protection NEMA rating	NEMA 1, 2, 3, 3R, 4, 4X, 12
Shock resistance	
• for railway applications acc. to DIN EN 61373	Category 1, Class B
Vibration resistance	

- for railway applications acc. to DIN EN 61373

Category 1, Class B



#### Mechanical data:

**Cable entry type** Without

#### Installation/ mounting/ dimensions:

**Height** 285 mm  
**Width** 85 mm  
**Depth** 64 mm  
**Mounting diameter** 22.3 mm

#### Certificates/approvals

General Product Approval	For use in hazardous locations	Declaration of Conformity	Test Certificates
 VDE		<a href="#">Herstellererklärung</a>  EG-Konf.	<a href="#">Werksbescheinigung</a> <a href="#">gen</a> <a href="#">spezielle Prüfbescheinigung</a> <a href="#">n</a>

#### other

[Bestätigungen](#)

#### Further information

**Information- and Downloadcenter (Catalogs, Brochures,...)**

<http://www.siemens.com/industrial-controls/catalogs>

**Industry Mall (Online ordering system)**

<https://mall.industry.siemens.com/mall/en/en/Catalog/product?mlfb=3SU18560AA000AB1>

**Cax online generator**

<http://support.automation.siemens.com/WW/CAXorder/default.aspx?lang=en&mlfb=3SU18560AA000AB1>

**Service&Support (Manuals, Certificates, Characteristics, FAQs,...)**

<https://support.industry.siemens.com/cs/ww/en/ps/3SU18560AA000AB1>

**Image database (product images, 2D dimension drawings, 3D models, device circuit diagrams, EPLAN macros, ...)**

[http://www.automation.siemens.com/bilddb/cax\\_de.aspx?mlfb=3SU18560AA000AB1&lang=en](http://www.automation.siemens.com/bilddb/cax_de.aspx?mlfb=3SU18560AA000AB1&lang=en)

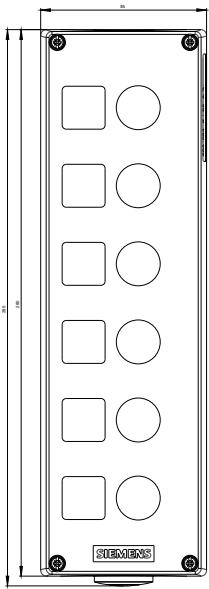

last modified:

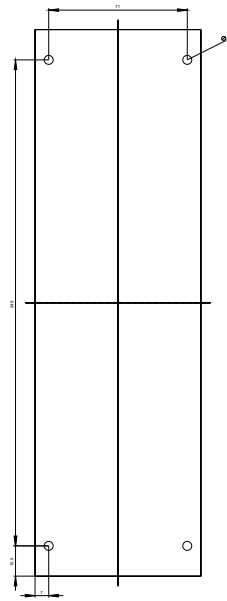
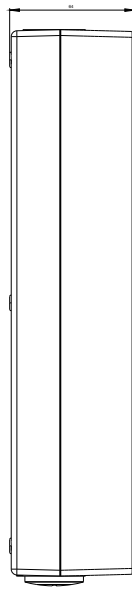

12.04.2016