

NSYSFPSC50

Post fixing device WM Spacial, length 500. For post max 675. Max. Load:100kg.

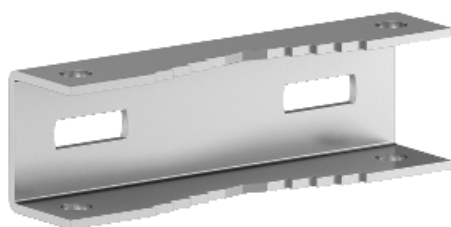

Price* : 51.79 GBP



Main

| | |
|------------------------------------|--|
| Range | Spacial |
| Accessory / separate part category | Fixing accessory |
| Product or component type | Post fixing device |
| Application | Multi-purpose |
| For enclosure nominal dimensions | - |
| Mounting location | Rear of enclosure |
| Range compatibility | Spacial CRN Spacial S3D Spacial SBM |
| Device composition | 2 x support rail 2 x strip Fixing elements |
| Quantity per set | Set of 1 |

Complementary

| | |
|----------------------------|--|
| Material | Galvanised steel |
| Fixing mode | Minimum diameter 150 mm Maximum diameter 215 mm By fixing element - screw type M8 - to the inserts in the rear of the enclosure location |
| Permanent permissible load | 100 kg |
| Height | 45 mm |
| Width | 495 mm |
| Depth | 32.5 mm |
| Product weight | 2.588 kg |

Offer Sustainability

| | |
|--------------------------|---|
| Sustainable offer status | Green Premium product |
| RoHS (date code: YYWW) | Compliant - since 0940 - Schneider Electric declaration of conformity |

 [Schneider Electric declaration of conformity](#)

| | |
|----------------------------------|--|
| REACH | Reference not containing SVHC above the threshold Reference not containing SVHC above the threshold |
| Product environmental profile | Available  Product Environmental Profile |
| Product end of life instructions | Need no specific recycling operations |

Contractual warranty

| | |
|-----------------|-----------|
| Warranty period | 18 months |
|-----------------|-----------|