

CLW-0612-W2E-EA series

12V / 0.5A Wall Mounted Type Constant Voltage Power Supply



■ Features:

- Universal AC input / Full range
- ErP step II / CEC level V compliance
- Protections: Over current / Short circuit



ELECTRICAL SPECIFICATION

MODEL	CLW 0612 W2E EA
OUTPUT	
Rated Voltage	12V
Rated Current	1A
Current Range	0 ÷ 0.5A
Rated Power	6W
Line Regulation	± 1%
Load Regulation	± 5%
Tolerance [3]	± 5%
Ripple & Noise (max.) [2]	100mV _{p-p}
Setup, Rise Time [4]	3000ms, 50ms / 230VAC at full load
Hold up Time (typ.)	8ms / 230VAC at full load
INPUT	
Voltage Range	90 ÷ 264VAC
Frequency Range	47 ÷ 63Hz
Efficiency (typ.)	73,4%
AC Current (typ.)	0.5A / 115VAC, 0.25A / 230VAC
Inrush Current (typ.)	30A / 115VAC, 60A / 230VAC
Leakage Current (max.)	0.25mA / 240VAC
PROTECTIONS	
Over Current	Type: hiccup mode, auto-recovery.
Short Circuit	Type: hiccup mode, auto-recovery.

CLW-0612-W2E-EA series



12V / 0.5A Wall Mounted Type Constant Voltage Power Supply

WORKING ENVIRONMENT

Working Temperature	0°C ÷ 40°C
Working Humidity	10 ÷ 90% RH non-condensing
Storage Temperature and Humidity	-20°C ÷ 85°C, 5 ÷ 90% RH non-condensing

SAFETY and EMC REGULATIONS

Safety Standards	Compliance to EN 60950-1
Withstand Voltage	IN/OUT: 4242kVDC
Isolation Resistance	IN/OUT: 50MΩ/500VDC/25°C/70%
EMC Emission	Compliance to EN55032
EMC Immunity	EN61000-4-2, -3, 4, 5, 6, 8, 11
Harmonic Current	Compliance to EN61000-3-3; EN61000-3-2

OTHERS

Dimensions	25 x 35 x 55mm (L x W x H)
Weight	70g

MECHANICAL SPECIFICATION

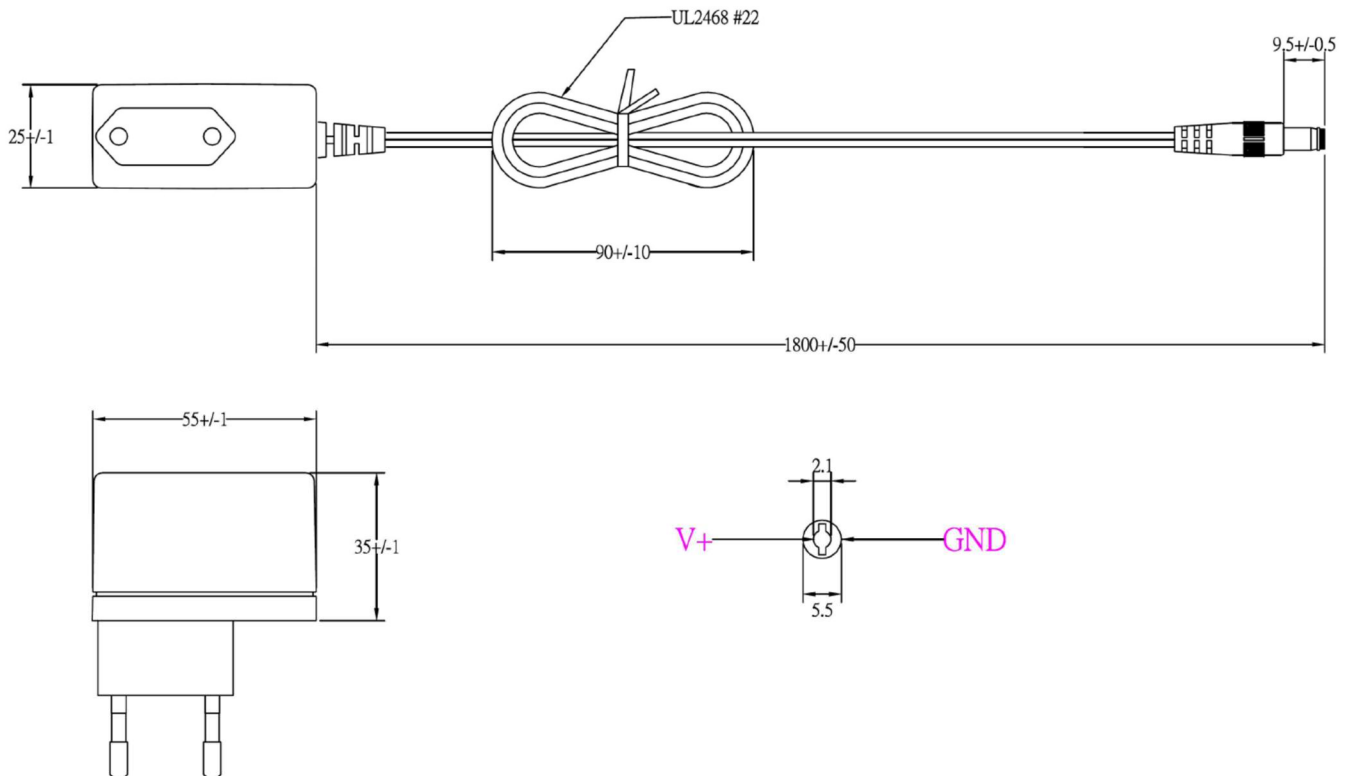

CLW-0612-W2E-EA series

12V / 0.5A Wall Mounted Type Constant Voltage Power Supply

