

REV.	ECON. NO.	DATE	SIGN	DESCRIPTION

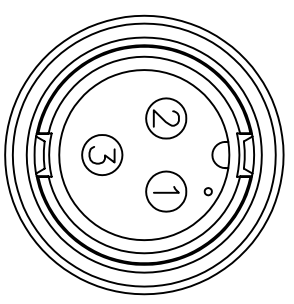

Pin Assignments
Front View

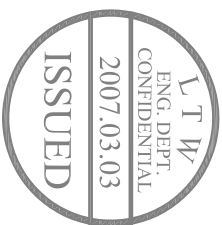
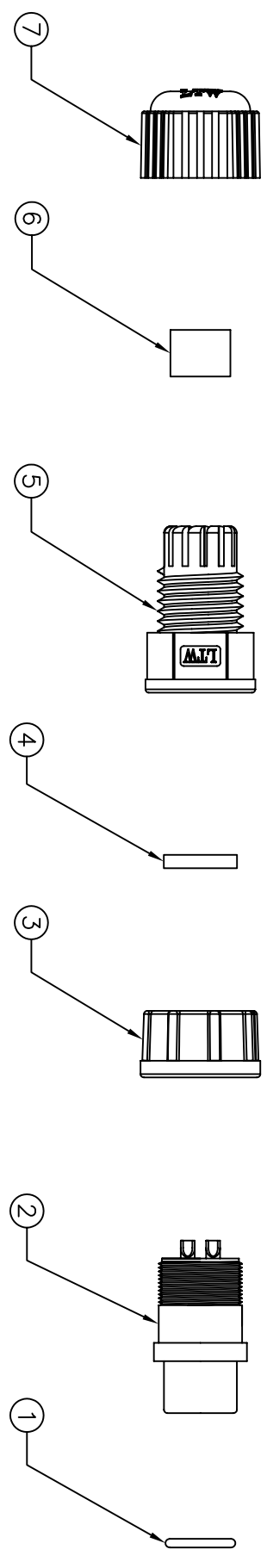
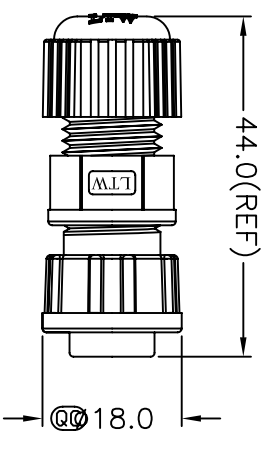

- Note:
- * @Important Dimension To Check.
 - * Waterproof Rate: IP67
 - * Housing: Black, Nylon+GF
 - * Pin: Copper Alloy, Gold Plated
 - * Nut: Black, Nylon+GF
 - * Ring: Black, EPDM
 - * Gasket: Black, EPDM
 - * Clamp Ring: Black, Nylon
 - * Sealing Nut: Black, Nylon
 - * Seals: Black, EPDM
 - * Seal For Cable OD: $\phi 4.5\text{mm} \sim \phi 6.5\text{mm}$
 - * One Set Unassembled In One PE Bag

UNIT:mm	
TOLERANCE	
X	± 0.25
.XX	± 0.1
.XXX	± 0.05
ANGLES	$\pm 1'$

TITLE	Standard				
Assy	Lock	3Pin	F Conn.	M Pin	
SCALE	Free	SHEET	1	OF	1
REV.	A	SIZE	A4	@@	:inspection Item

LTW
亮泰企業股份有限公司

ITEM NO.	LTWBB-03BFMA-LL7001
DWG NO.	LTWBB-03BFMA-LL7001
CUSTOMER	

DRAWN BY	Allian Frank Valentino	DATE	2007/02/07
CHECKED BY	Robert Dabu	DATE	2007/02/14
APPROVED BY	Win	DATE	2007/02/14
