

REV.	EGN. NO.	DATE	SIGN	DESCRIPTION

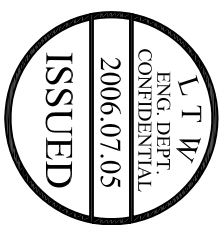

- Note:
- \* @Important Dimension To Check.
  - \* Waterproof Rate: IP67
  - \* Housing: Black, Nylon+GF
  - \* Pin: Copper Alloy, Gold Plated
  - \* Nut: Black, Nylon+GF
  - \* Ring: Black, EPDM
  - \* Gasket: Black, EPDM
  - \* Clamp Ring: Black, Nylon
  - \* Sealing Nut: Black, Nylon
  - \* Seals: Black, EPDM
  - \* Seal For Cable OD:  $\phi 4.5\text{mm} \sim \phi 6.5\text{mm}$
  - \* One Set Unassembled In One PE Bag

Pin Assignments  
Front View

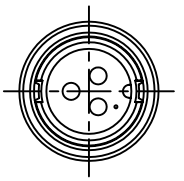
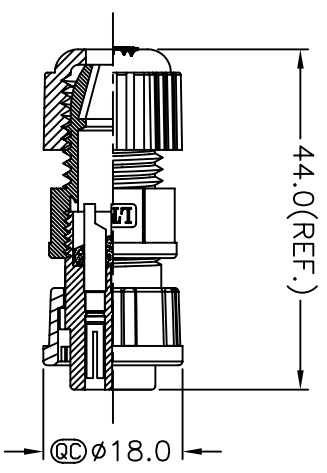
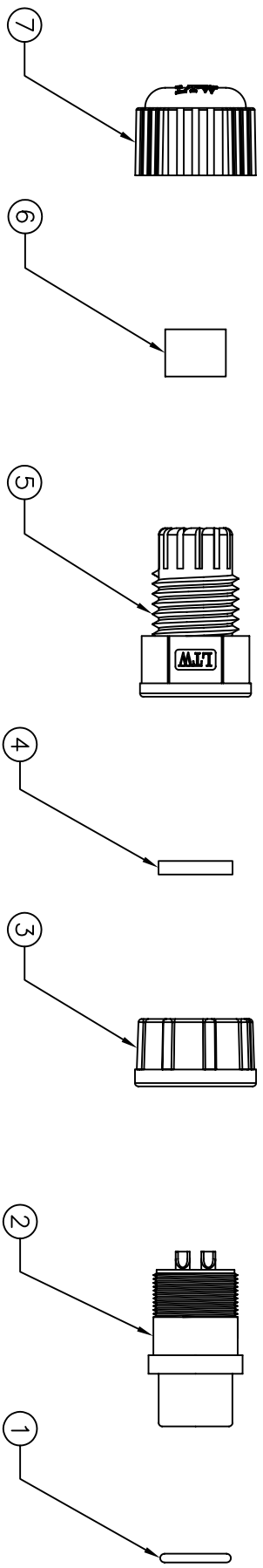
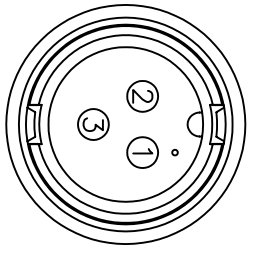

UNIT:mm TOLERANCE $\pm 0.5\text{ mm}$	TITLE Standard Assy Lock 3Pin F Conn F Pin	SCALE Free	SHEET 1	OF 1	ITEM NO LTW/BB-03BFFA-LL7001	DRAWN BY Ronald Bondoc	DATE 2006/06/30
REV. A	SIZE A4	: Inspection Item		LTW	DWG NO LTW/BB-03BFFA-LL7001	CHECKED BY Robert Dabu	DATE 2006/06/30
亮泰企業股份有限公司				Conn.	CUSTOMER	APPROVED BY Win	DATE 2006/07/03