

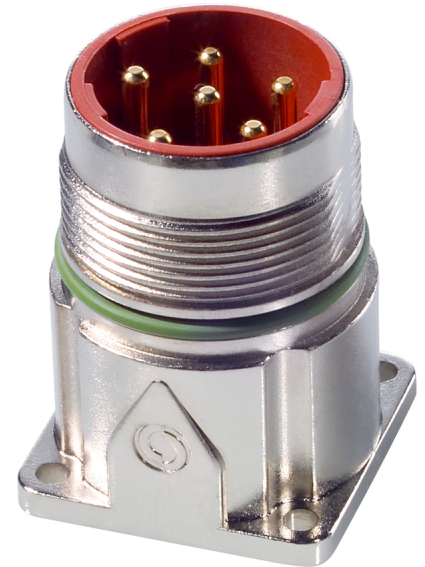











| | | |
|-------------------|-----------------------------------|--|
| U.I. Lapp GmbH | <h1>DATASHEET</h1> |  |
| | EPIC KIT LS1 A1 8-POL MALE | 75009695 29.11.2013 |

Circular connectors for servomotors and power supply
 High power at smallest installation space, Optimal solution for electric motors
 EMC-optimised
 Safety use in field environment by high protection class



-  Good chemical resistance
-  Corrosion-resistant
-  Industrial machinery and plant engineering
-  Maximum vibration protection
-  Mechanical resistance
-  Assembly time
-  Space requirement
-  Robust
-  Waterproof
-  Wind Energy
-  Variety of approval certifications

Application range

Plant engineering
 Servo drives and servo assemblies

Remark

Photographs are not to scale and do not represent detailed images of the respective products.

| | | |
|--------------------|--------------------------------------|-------|
| Product Management | Document: EPIC KIT LS1 A1 8-POL MALE | 1 / 3 |
|--------------------|--------------------------------------|-------|

| | | |
|-------------------|-----------------------------------|--|
| U.I. Lapp GmbH | DATASHEET |  |
| | EPIC KIT LS1 A1 8-POL MALE | 75009695 29.11.2013 |

Technical Data

| | |
|--------------------------------|---|
| Article number: | 75009695 |
| Rated voltage (V): | 630 V (2 mm contacts) 250 V (1 mm contacts) |
| Rated impulse voltage: | 6 kV (2 mm contacts) 4 kV (1 mm contacts) |
| Rated current (A): | 26A/3+PE+4, 25A/5+PE (2mm contacts) 7 A (1 mm contacts) |
| Contact resistance: | < 4 mOhm |
| Contacts: | Gold-plated brass |
| Number of contacts: | 3 + PE + 4 5 + PE |
| Termination methods: | Crimp termination: 0.5 - 2.5 mm ² (2 mm contacts) Crimp termination: 0.14 - 1.0 mm ² (1 mm contacts) |
| Material: | Housing: nickel-plated zinc die-casting, nickel-plated brass Insert: PA, Seal: FPM |
| Protection rating: | IP68 (10h / 1m) |
| Cycle of mechanical operation: | 500 |
| Temperature range: | -25°C až +125°C |
| VDE-tested: | Certified production control: VDE-REG. no. B25 |
| Degree of soiling: | 3 |

| | | |
|--------------------|--------------------------------------|-------|
| Product Management | Document: EPIC KIT LS1 A1 8-POL MALE | 2 / 3 |
|--------------------|--------------------------------------|-------|

| | | |
|-------------------|-----------------------------------|--|
| U.I. Lapp GmbH | DATASHEET |  |
| | EPIC KIT LS1 A1 8-POL MALE | 75009695 29.11.2013 |

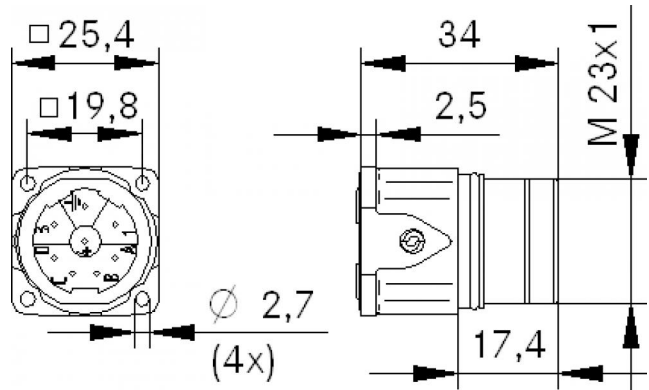

| | | |
|--------------------|--------------------------------------|-------|
| Product Management | Document: EPIC KIT LS1 A1 8-POL MALE | 3 / 3 |
|--------------------|--------------------------------------|-------|