

5

4

3

2

1

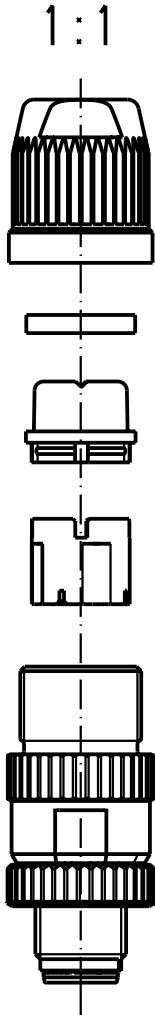

1:1

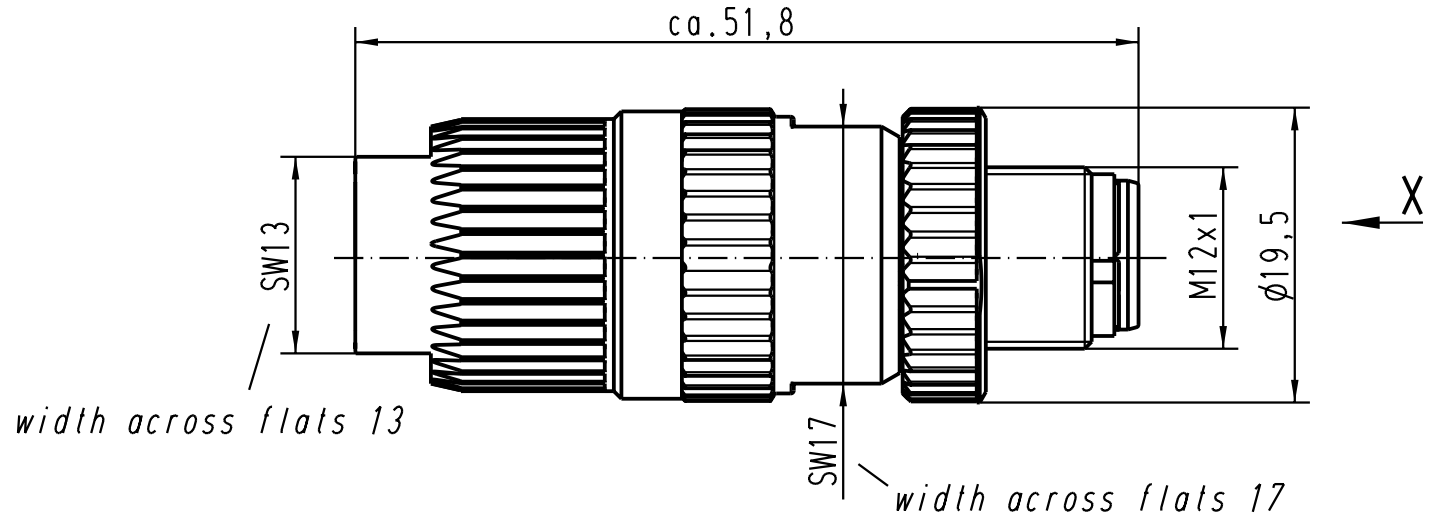

width across flats 13

width across flats 17

Steckgesicht n.
Contact face acc.
IEC 61076-2-101

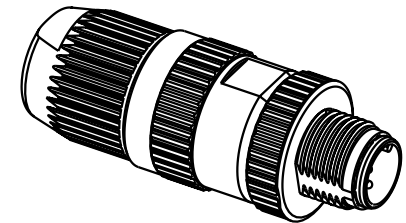
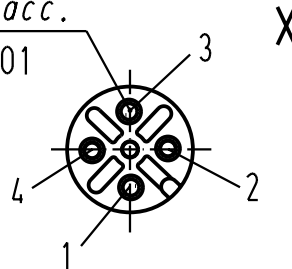

All Dimensions in mm Original Size DIN A 4		Techn. Character.			Nicht tolerierte Masse/ Free size tolerances	
			Dat.	Name	Massstab/ Scale 2:1 1:1	Rundsteckverbinder M12-L Circular connector M12-L A-kodiert, geschirmt A-coded, shielded
		Detail.	10.03.04	DY		
		Insp.		SR		
		Stand.				
410925		HARTING Electric GmbH & Co. KG				TB 21 03 221 1405
Mod.	Dat.	Name	D-32339 Espelkamp			
Sub.						Blatt/ page

D

C

B

A