

REV	ZONE	DESCRIPTION\PCR REQUEST\DATE

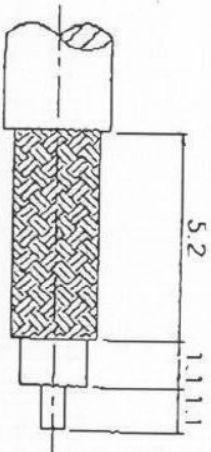

RECOMMENDED  
CABLE STRIPPING DIM'S  
(建議剝線尺寸)

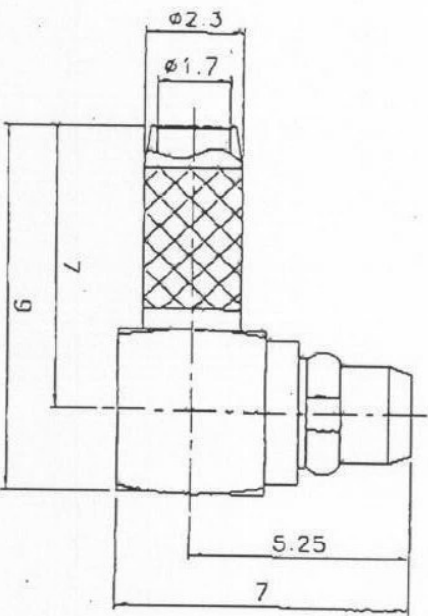
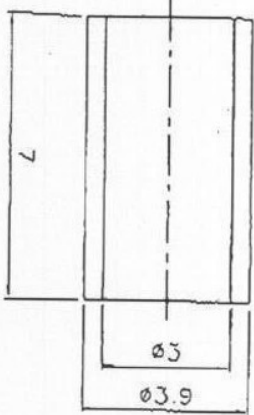

1. CRIMPED FERRULE  
HEX. CRIMP SIZE .128"
2. CONTACT PIN TO SOLDER

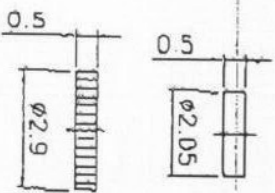

NO.	DESCRIPTION	MATERIAL	FINISH	QTY	DRAWING NO.
7	CAP	BRASS	GOLD	1	CV01-0001G-0
6	INSULATOR	POH	NATURAL	1	NS01-0002W-0
5	FERRULE	BRASS	GOLD	1	FR00-0001G-0
4	RING	BERYLLIUM COPPER	GOLD	1	LR01-0001G-0
3	CONTACT PIN	BRASS	GOLD Au	1	CP01-0001G-0
2	INSULATOR	PIRE	NATURAL	1	NS01-0001W-0
1	BODY	BRASS	GOLD	1	DP01-0001G-0

DIMENSIONS ARE IN MILLIMETERS  
THICKNESS DIMENSIONS SPECIFIED  
TOLERANCES

ANGLES = 2.5°  
UP TO 6 = ±0.1  
6-40 = ±0.2  
40-120 = ±0.6  
120-315 = ±1.1  
ABOVE 315 = ±1.6

TITLE MMXX R/A PLUG CRIMP  
(FOR RG-174/U, 316/U) MS2306 P

DRAWING NO. MMXXPRA-1

CUSTOMER NO. TC-1403-TBGC\11 02-18-13

REV 0

1 2 3 4 5 6 7 8