

This document is the property of Amphenol Corporation and is delivered on the express condition that it is not to be duplicated, reproduced or used, in whole or in part, for any purpose other than that for which it was prepared by Amphenol Corporation without its prior consent, and that no right is granted to disclose or to use any information in this document.

REVISIONS		
S/N	DESCRIPTION	DATE
A		09/10/07

D-SUB TECHNICAL DATA

SHELL : Steel 2.5um(100u") min tin over 1.25um(50u") min nickel
 BODY : Glass filled thermoplastic.
 Flame retardant to UL94 V-0 Color Black

CONTACTS : brass
 gold flash over 1.25um(50u") min nickel on mating area.
 2.5um(100u") min sn over 1.25um(50u") min nickel on solder area

ELECTRICAL : Voltage rating : 250 V RMS at 50 Hz
 Current rating :1A
 Withstanding Voltage >1000 V Rms to 50 Hz for one minute
 Insulation resistance >5000 M Ohms
 Contact resistance 20 mOhms max.

CLIMATIC : Temperature range -55 °C up to 125°C
 MACHANICAL : Insertion force per contact 3.41N Max
 Extraction force per contact 0.21N Min.

MARKING : Amphenol...(Series No.)
 Commercial reference
 Manufacturing date

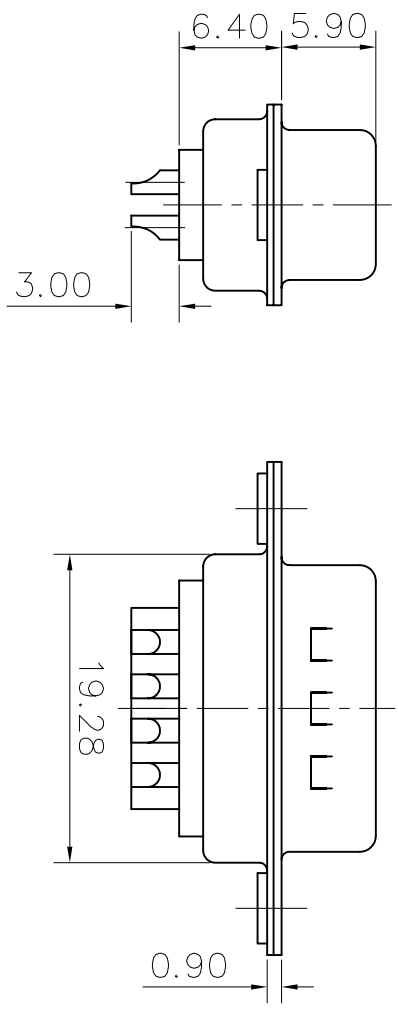
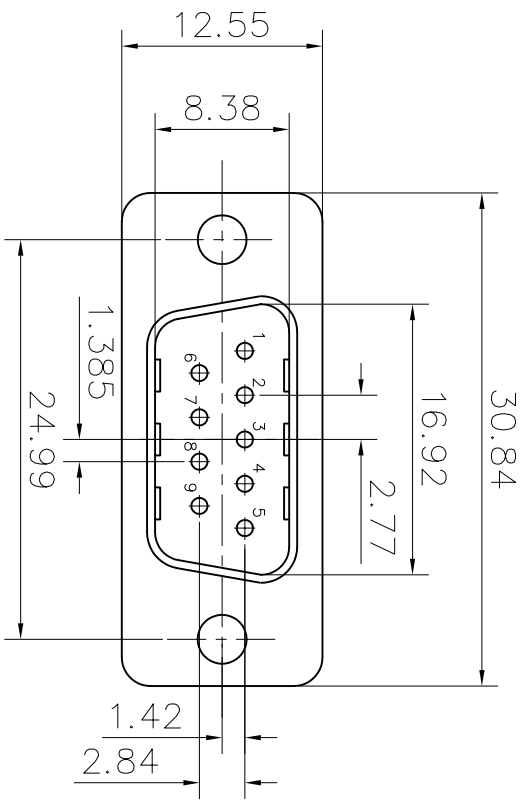

PRODUCT CODE

L717SD E 09 P

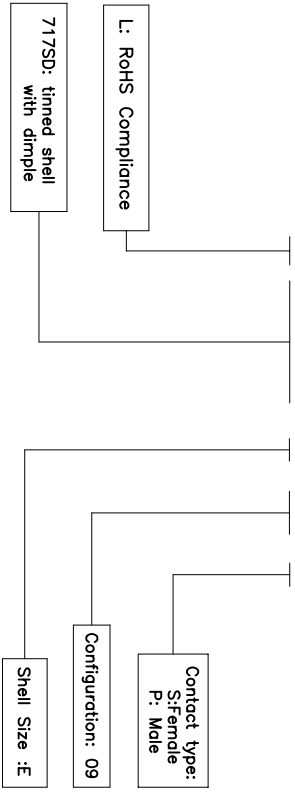

Amphenol

DIMENSIONS SPECIFIED		APPROVAL	DATE
TOLERANCES	METRIC	DRAWN	Checked and D0/10/07
U.S.		CHECKED	10k. Wang D0/10/07
X	±0.50		
XX	±0.30		
XXX	±0.20		
ANGLES	±1/4°		
FINISHES	Z		

FOR MATERIALS AND FINISHES		DRAWING FILE :	
REMOVE SHARP EDGES		ANGLE OF PROJECTION	
DIMENSIONS	INCHES		
FINISHES	MM		
TEXT	MM		

TITLE			
Stamped and Formed connector, SD series			
SIZE	DRAWING NO.	REV.	
A4	C L717SD E09 P	A	
SCALE	NONE	SHEET	1 OF 1

