

This document is the property of Amphenol Corporation and is prepared on the express condition that it is not to be duplicated, reproduced or used, in whole or in part, without the prior consent, in writing, of Amphenol Corporation. No part of this document is to be used for any other purpose or to use any information in this document.

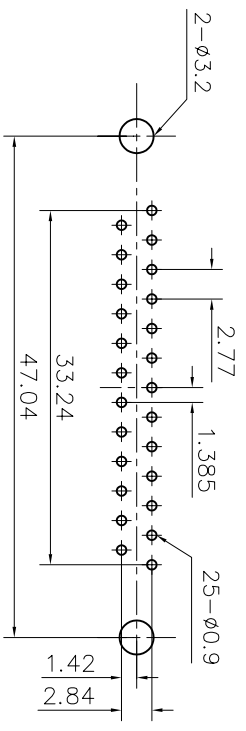

RECOMMENDED P.C.B. LAYOUT
(TOLERANCE +/-0.03)

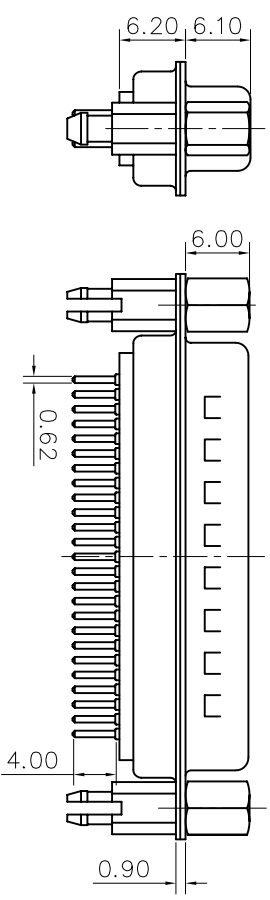
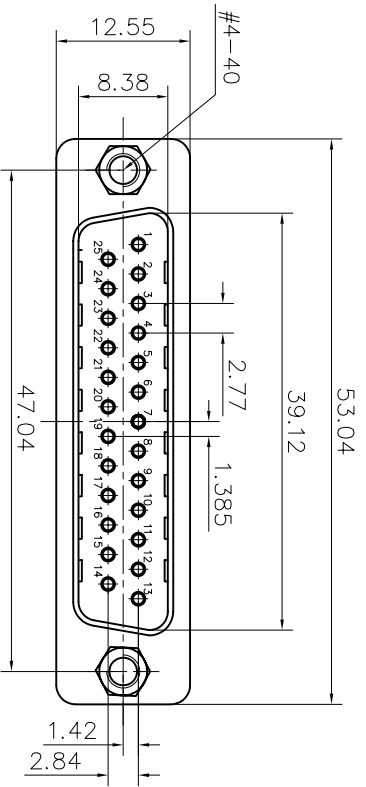

REVISONS		DATE	APPROVED
1	DESCRIPTION	09/10/07	
2			
3			
4			

D-SUB TECHNICAL DATA

SHELL : Steel, 100u" min. sn over 50u" min. nickel
 BODY : Glass filled thermoplastic.
 Flame retardant to UL94 V-0 Color Black
 CONTACTS : Brass
 gold flash over 1.25um(50u") min nickel on mating area.
 2.5um(100u") min sn over 1.25um(50u") min nickel on solder area
 BOARDLOCK: Copper alloy 100u" sn min over 50u" min nickel
 REAR INSERT: Brass, 100u" sn over 50u" nickel
 ELECTRICAL : Voltage rating : 250 V RMS at 50 Hz
 FRONT SCREWLOCK: Brass, 100u" sn over 50u" nickel
 Current rating :3A
 Withstanding Voltage >1000 V Rms to 60 Hz for one minute
 Insulation resistance >5000 M Ohms
 Contact resistance 25 mOhms max.
 CLIMATIC : Temperature range -55 °C up to 125°C
 MECHANICAL : Insertion force per contact 3.41N Max
 Extraction force per contact 0.21N Min.
 MARKING : Amphenol---(Series No.)
 Commercial reference
 Manufacturing date

PRODUCT CODE

L 717SD BH 25 P OL2 RM8

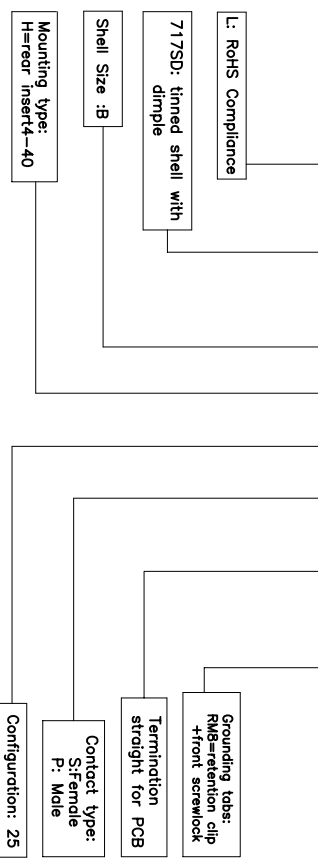

DIMENSIONS SPECIFIED		APPROVAL		DATE	
TOLERANCES	METRIC	DRAWN	Checked and	09/10/07	
	U.S.	CHECKED	14k. using	09/10/07	
.X	+/-				
.XX	+/-				
.XXX	+/-				
FRACTIONS	+/-				
ANGLES	+/-				
FOR MATERIALS AND FINISHES		DRAWING FILE :			
REMOVE SHARP EDGES		ANGLE OF PROJECTION			
DIMENSIONS		TYPICAL			
FINISH		NONE			
MATERIAL		NONE			
TITLE		Stamped and Formed connector, SD series			
SIZE		DRAWING NO.		REV.	
A4		C L717SDBH25POL2RM8		B	
SCALE		NONE		SHEET 1 OF 1	

Amphenol

4 3 2 1