

**D-Sub Full Metal, Top cable entry**

**TECHNICAL SPECIFICATIONS**

Material: Zinc, Nickel Plated

Operating Temperature: -45°C to + 105°C

Cable Entry: Top Entry

Thumbscrews: UNC 4-40 (Standard)

Cable O.D.:  
 9-Way Up to 9,5mm  
 15-Way Up to 9,5mm  
 25-Way Up to 9,5mm  
 37-Way Up to 12,0mm



**Features:**

- Available in sizes 9-15-25-37
- Excellent EMI Shielding
- Re-openable
- Spring-Clip mounted Jackscrews
- Available without rubber grommet on request

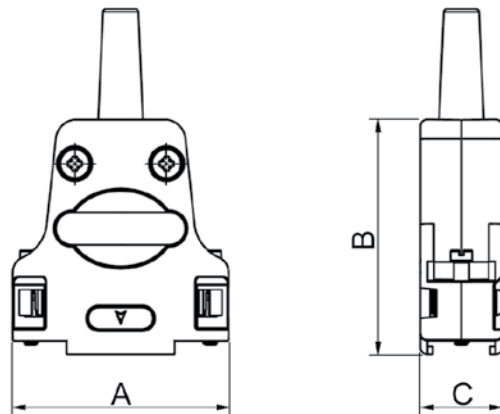

Size D45ZF	Dim A	Dim B	Dim C
9-way	31,6	39,5	15,2
15-way	40,0	41,0	15,2
25-way	53,7	47,5	15,2
37-way	70,2	48,0	15,2

**Ordering information:**

Size:	P/N - Kitted:	Product Code:
9-way	7960-0205-01	DTZF09-RG-K
15-way	7960-0205-02	DTZF15-RG-K
25-way	7960-0205-03	DTZF25-RG-K
37-way	7960-0205-04	DTZF37-RG-K

Size:	P/N - BULK:	Product Code:
9-way	7961-0205-01	DTZF09-RG
15-way	7961-0205-02	DTZF15-RG
25-way	7961-0205-03	DTZF25-RG
37-way	7961-0205-04	DTZF37-RG