

ISS.	AMEND	DATE
1	REDRAWN	11/1/91
2	REDRAWN	15/6/92
3	PC-C ADDED	4/12/92
4	DIMS CORRECT	18/8/94
5	T TYPE ADD	15/3/95
6	PCA/S REDRAWN	13/4/95
7	PCA SPIKY ADD	8/1/96
8	DIMS CORRECT	20/2/96
9	SEE MOD 0214	9/8/96
10	SEE MOD 0221	14/3/97
11	WASHER MTL	29/6/01

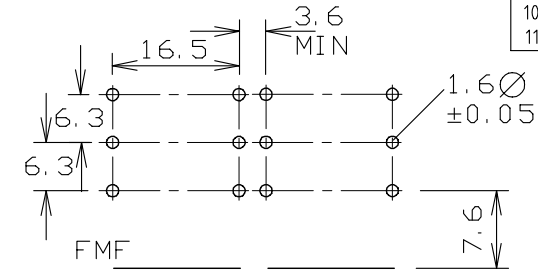

PC GRID TYPES A/S, A & B

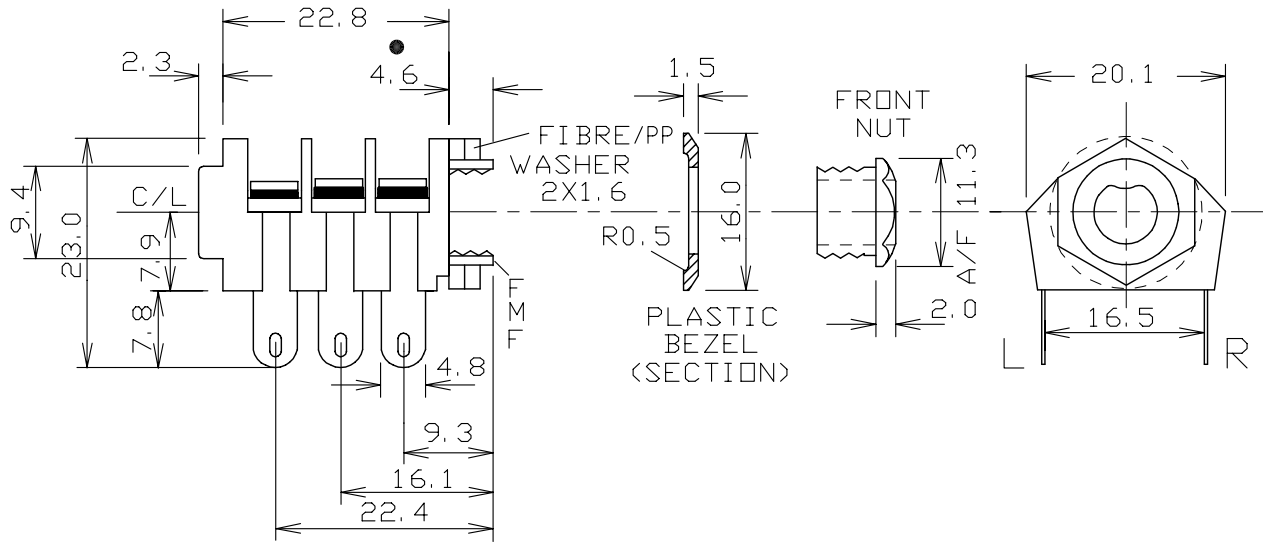
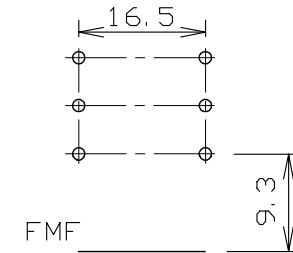

PC GRID-TYPES C, D, E

OPTION  
S4P HAS COMBINED NUT & BEZEL MADE FROM PLASTIC MATT BLACK FINISH.

NOTE  
S4T JACKS HAVE ALL CONTACTS PLATED WITH LOW LOSS FINISH.

NOTE  
'REVERSED CONTACT' HAS LONG CONTACTS ON L AND SHORT ON R.

FOR KINKED LEG JACK SOCKETS, USE 1.5 ± 0.05Ø P.C.B. HOLE.

MAX PANEL THICKNESS 4.3mm

**RoHS**  
COMPLIANT

**Tolerance**  
NO DEC. PLACE ±  
1 DEC. PLACE ± 0.2  
2 DEC. PLACE ±  
DIA. HOLES ±  
ANGLES ± 1/2°  
UNLESS OTHERWISE STATED

WHERE USED F.R.

SCALE N.T.S.

BACK OF SOCKET ← → FRONT OF SOCKET

<p>SPECIAL REVERSED CUT CONTACT</p> <p>12.5 TO C/L</p> <p>(12.5 = SPECIAL)</p> <p>PCA/S/REV</p>	<p>12.5 TO C/L</p> <p>1.3 WIDE</p> <p>3.2</p> <p>(12.5 = SPECIAL)</p> <p>PC TYPE A/S</p>	<p>10.0 TO C/L</p> <p>4</p> <p>3</p> <p>1.3 WIDE</p> <p>PC TYPE A</p>	<p>1.3 WIDE</p> <p>4.1</p> <p>PC TYPE B</p>	<p>4.3</p> <p>1.3 WIDE</p> <p>PC TYPE C</p>
<p>10.0 TO C/L</p> <p>5.7</p> <p>PRODUCED BY CUTTING FROM A STD. SOLDER TAG TYPE</p> <p>PCA "SPIKY"</p>	<p>1.30 (x2)</p> <p>4.3 (x2)</p> <p>0.80</p> <p>0.85 (x2)</p> <p>R0.90 (x2)</p> <p>1.4 (x2)</p> <p>16.8 ± 0.2</p> <p>PC-C 'KINKED'</p>	<p>15mm TO C/L</p> <p>4.0</p> <p>1.3 WIDE</p> <p>PC TYPE D</p>	<p>17.5 TO C/L</p> <p>4.0</p> <p>1.3 WIDE</p> <p>PC TYPE E</p>	

DIMENSIONS IN MILLIMETERS UNLESS OTHERWISE STATED. WORK TO DIMENSIONS. DO NOT SCALE DRAWING. 3rd ANGLE PROJECTION. REMOVE BURRS. IF IN DOUBT ASK.

Cliff Electronic Components Limited  
76 Holmehorpe Ave., Holmehorpe Ind. Estate,  
Redhill, Surrey. RH1 2PF. England.  
Tel: 01737-771375 Fax: 01737-766012

MATERIAL NYLON / NIAG / FIBRE / PP  
FINISH AS MOULDED / MICROFINISH  
DRAWN C.A.M.J. APPD. RWT

TITLE S4 JACK SOCKET

DRWG. No. CL128205

FORM: A4DRWGH