

0911 Push Button Snap Action Switches Up to 16(4)A 250Vac



C0911KB ---



C0911RB --- C0911PB ---

- ▶ Snap action switches
- ▶ Ratings up to 16A, 250Vac
- ▶ Round and rectangular buttons

Approvals and specifications



16(4)A 250Vac 5E4 T85



16A 125/250Vac 3/4hp T85 50E3

125V 1/2 HP, 250V 3/4 HP, 0.4A 125Vdc, 0.2A 250Vdc

Approvals apply to switch mechanism only.
μ contact gap.



push switches

▶ TERMINAL	▶ FUNCTION	▶ ACTUATOR	BODY	▶ OPTIONS
<p>C</p> <p>6.3 x 0.8</p>	<p>0911</p> <p>ON - ON (momentary)</p>	<p>R Rectangular bezel</p> <p>P Short</p> <p>K with satin chrome bezel</p> <p>N with nylon bezel</p>	<p>B</p> <p>Panel Cut-out</p> <p>Panel thickness Both nuts 2.5mm No backnut 4.0mm</p>	<p>Colour</p> <p>Call sales for custom colours. A full range is available for larger orders.</p>

Dimensions (mm)

R

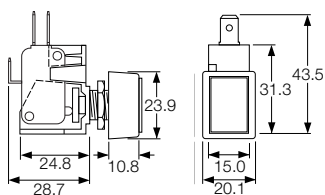

P

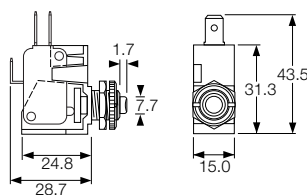

K & N

